

# beluga

**Beluga *Bluetooth*<sup>®</sup> Intelligent Handset**

**and**

**Charging Station**

**(Model BCK-0808)**

**User Guide**

## Table of Contents

<b>INTRODUCTION.....</b>	<b>3</b>
<b>PACKING LIST .....</b>	<b>3</b>
<b>WARNING .....</b>	<b>3</b>
<b>PROTECT YOUR HEARING .....</b>	<b>3</b>
<b>SAFETY INSTRUCTIONS.....</b>	<b>4</b>
<b>BELUGA HANDSET AND BUILT-IN BATTERY CARE.....</b>	<b>5</b>
<b>CHARGING STATION CARE.....</b>	<b>5</b>
<b>PACKAGING AND PRODUCT DISPOSAL .....</b>	<b>5</b>
<b>BELUGA OVERVIEW.....</b>	<b>6</b>
<b>BEFORE USE .....</b>	<b>7</b>
<b>GENERAL OPERATIONS.....</b>	<b>7</b>
<b>PAIRING THE BELUGA.....</b>	<b>8</b>
<b>SPECIFICATIONS .....</b>	<b>18</b>
<b>TROUBLESHOOTING .....</b>	<b>19</b>
<b>WARRANTY INFORMATION.....</b>	<b>19</b>
<b>FCC NOTICE .....</b>	<b>19</b>
<b>CE .....</b>	<b>20</b>
<b>RoHS COMPLIANCE .....</b>	<b>20</b>
<b>END USER LICENSE AGREEMENT.....</b>	<b>21</b>
<b>WARRANTY DISCLAIMER .....</b>	<b>22</b>
<b>LIMITATION OF LIABILITY .....</b>	<b>22</b>
<b>COMPLIANCE WITH LAWS .....</b>	<b>22</b>

## INTRODUCTION

Thank you for purchasing the Beluga Bluetooth Intelligent Handset and Charging Station (Model BCK-0808). Before attempting to use your Beluga, please confirm all of the items listed below are present:

### PACKING LIST

- |   |         |
|---|---------|
| 1. Beluga Bluetooth Intelligent Handset | 1 piece |
| 2. Charging Station                     | 1 piece |
| 3. User Guide & Warranty Card           | 1 piece |
| 4. MicroUSB Cable Charging Cable        | 1 piece |

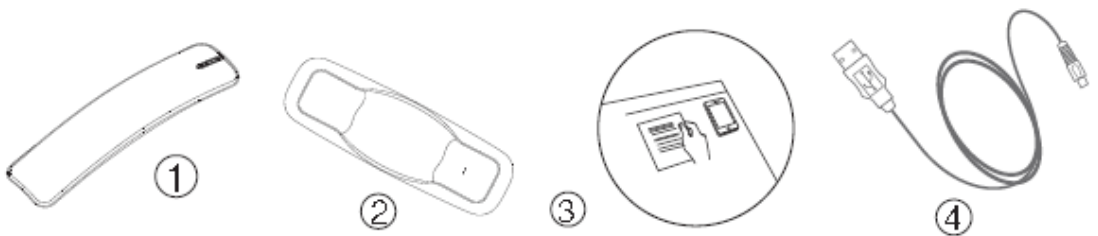

### WARNING

Failure to follow the safety instructions that follow could result in hearing damage, fire, electric shock, or other serious injury.

### PROTECT YOUR HEARING

Permanent hearing loss may occur if the Beluga handset is used at a high volume. Set the volume to a safe level. Even though you may become accustomed to a higher level of sound, and even though it may sound normal, any higher level of sound can be damaging to your hearing. If you experience ringing in your ears or muffled speech, stop using the handset and have your hearing checked. The louder the volume, the less time is required before your hearing could be seriously affected. The Beluga handset has been configured at the factory to a medium volume level. Do not increase the level of volume unless you are in conditions where you need a higher level for a short period of time. If this level of volume is uncomfortably high for you, decrease the level. To protect your hearing, we suggest:

1. Limiting the amount of time you use the Beluga handset, especially at high volume levels.
2. Avoid increasing the volume to block out noisy surroundings.
3. Decrease the volume if you can't hear people speaking near you.

## **SAFETY INSTRUCTIONS**

- Do not expose the Beluga handset or the charging station to liquids, humid areas, or rain. The Beluga is not waterproof.
- Never use the Beluga handset while taking a bath.
- Do not use the Beluga handset in a sauna or steam room.
- Do not keep your Beluga handset near a sink or other wet areas.
- Do not use abrasive cleaners to clean the Beluga.
- Do not tamper with or abuse the Beluga handset or the charging station. Do not drop, disassemble, crush, deform, puncture, microwave, incinerate, paint, or insert any foreign object into any of the Beluga components.
- Do not bring the Beluga into contact with any sharp objects, as scratches and damage may result.
- Never allow children to play with the Beluga handset or charging station.
- Do not leave the Beluga in direct sunlight for extended periods.
- Do not leave the Beluga near open flames such as cooking burners.
- Do not expose the Beluga to extremely high or low temperatures.
- Do not leave or store the Beluga handset or any of its accessories in the area over an air bag or in the air bag deployment area of an automobile as serious injury may result when an air bag deploys.
- Observe local laws regarding the use of a mobile phone and handset while driving.
- If you use the Beluga handset while driving, ensure you maintain full attention and focus; it's your responsibility to drive safely. Consider pulling off the road before making or answering a call.
- Turn off your Beluga handset prior to boarding an aircraft.
- Do not use the Beluga handset inside an aircraft in flight unless permitted by the airline.
- Be alert to areas that require electrical or RF devices to be switched off in designated areas.

## **BELUGA HANDSET AND BUILT-IN BATTERY CARE**

- Do not attempt to replace the Beluga handset battery. It is embedded and not replaceable.
- Do not attempt to force open the embedded battery.
- Do not dispose of the Beluga handset in a fire. The embedded battery may explode.
- Only charge your Beluga handset's embedded battery in accordance with instructions set forth in this User Guide.
- Do not attempt to repair or modify the Beluga handset yourself. The Beluga handset does not contain any user-serviceable parts. If the Beluga handset has been submerged in water, punctured, or subjected to a severe drop, do not use it until a qualified service representative has inspected it.

## **CHARGING STATION CARE**

- Do not attempt to disassemble the charging station as it may expose you to dangerous electric shock.
- Do not use the charging station outdoors or in damp areas.
- Avoid charging your Beluga handset in extremely high or low temperatures.
- Do not clean your Beluga handset while it is being charged. Always lift the handset from the charging station first before cleaning.
- Please only use the supplied *MicroUSB Charging Cable* to charge the Beluga handset.

## **PACKAGING AND PRODUCT DISPOSAL**

- When necessary, dispose of the Beluga handset, its embedded battery, and charging station in accordance with local regulations. Do not dispose of the handset with common household waste.
- Dispose of the product packaging in accordance with local regulations.

## BELUGA OVERVIEW

1. Volume UP
2. Multi-Function Button
3. Volume DOWN
4. Charging Points
5. Power Pins
6. Multi-Function LED Indicator
7. USB Charge-IN (power input from your smart device power source)
8. USB Charge-OUT (power output to your smart device)
9. Earpiece
10. Microphone

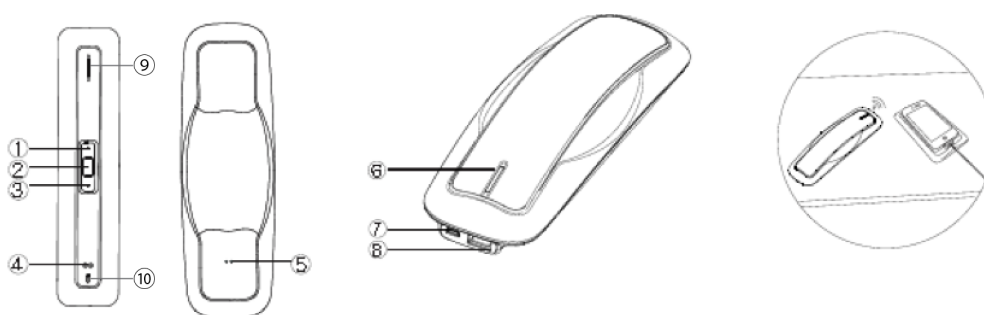

### Notes:

- **Multi-Function Button:** Used for powering the Beluga handset ON/OFF, pairing with a smart device via Bluetooth, initiating calls, answering calls, ending calls, rejecting calls, redialing the last number dialed, call swap, call hold, and other features, depending upon the smart device paired with the Beluga handset.
- **Volume UP/DOWN:** Used for adjusting the volume of your Beluga handset to a comfortable sound level, as well as activating other handset features described in this User Guide.
- **Charging Points/Power Pins:** Used for charging the Beluga handset through the supplied *MicroUSB Charging Cable*, connected to your smart device power source.
- **Multi-Function LED Indicator:** Used to indicate the status of the Beluga handset, as well as an indicator of different operational modes of the handset described in this User Guide.

## BEFORE USE

1. Make sure your smart device supports *Bluetooth*® 2.1 plus.
2. Make sure the Beluga handset is fully charged prior to initial use. For details on charging, please refer to *Charging the Beluga Handset* described on page 17 of this User Guide.
3. Pair the Beluga handset with your smart device prior to using. For details on pairing, please refer to *Pairing The Beluga* described on page 8 of this User Guide.

## GENERAL OPERATIONS

### Power-ON

Press and hold the *Multi-Function Button* for approximately 5 seconds. You will see the *LED Indicator* flashing blue during the power-ON phase, and audible scaling-up tones can be heard from the earpiece.

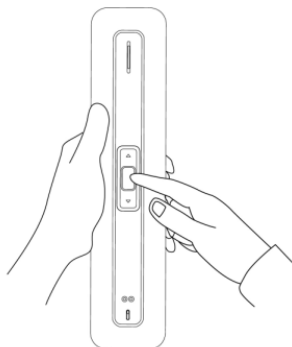

### Power-OFF

Press the *Multi-function Button* for 5 seconds, and you will see the *LED Indicator* glow steady red for 2 seconds, and audible scaling-down tones can be heard from the earpiece. The *LED Indicator* will then extinguish, and power is interrupted to the handset.

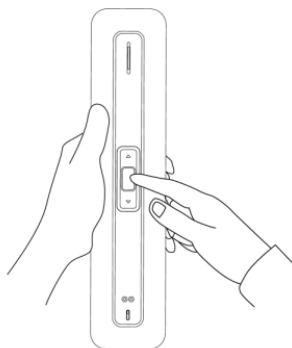

## PAIRING THE BELUGA

### Power-ON and Pairing the Beluga Handset

With the handset in the Power-OFF state (no *LED Indicators* flashing), press and hold the *Multi-Function Button* for approximately 10 seconds. You will see the *LED Indicator* flashing alternately in red and blue at half-second intervals. You have now entered the pairing mode on the Beluga handset. The Beluga handset will remain in the pairing mode for approximately 5 minutes. Please be sure to pair the Beluga handset with your smart device before the pairing time elapses. Throughout the pairing process, you will hear several audible sounds emitting from the handset earpiece. This is normal and serves as confirmation tones for various processes.

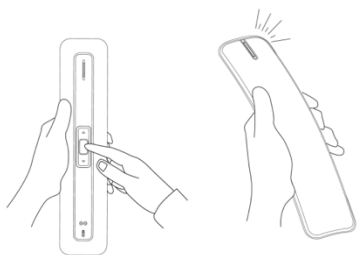

### Pairing the Smart Device with the Beluga Handset

1. Position your smart device and the Beluga handset to be as close to each other as possible, and no more that 1 meter (3.3 feet) apart.
2. Then, activate the Bluetooth function on your smart device. You should see the name “Beluga” appear under your list of Bluetooth devices within approximately 30 seconds of initiating pairing.
3. Touch the “Beluga” line item to commence pairing between the smart device and the Beluga handset. Note that some smart devices may require a passcode before pairing can be initiated. If so, please input “0000” to initiate pairing.

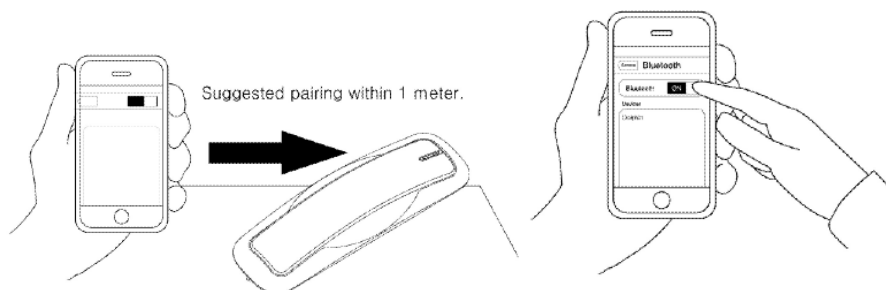

The Beluga handset has successfully paired with the smart device when the line items indicates “Connected” on the smart device, and the *LED Indicator* on the Beluga handset flashes blue once every 8 seconds. This indication confirms successful pairing, and the Beluga handset is in *standby mode*. You are now ready to use the Beluga handset with your smart device.



## OPERATING MODES

- *Pairing mode*: While in this mode, the Beluga handset is ready for pairing with a smart device via the smart device's Bluetooth connection. The *LED Indicator* alternately flashes red and blue while in the *pairing mode*.
- *Standby mode*: While in this mode, the Beluga handset has successfully paired with smart device through its Bluetooth connection, and is ready to receive and execute phone calls.

When the handset is fully charged on the *Charging Station*, the *LED Indicator* is solid blue, yet blinks at 8 second intervals indicating the handset is still connected with the smart device.

While charging the handset on the *Charging Station*, the *LED Indicator* is solid red, yet flashes blue at 8 second intervals indicating the handset is still connected with the smart device.

When the handset is off the *Charging Station*, the *LED Indicator* flashes blue at 8 second intervals indicating the handset is still connected with the smart device.

- *Disconnect mode*: While in this mode, the handset is powered but not paired with any smart device. If the handset remains in *disconnect mode* for more than 15 minutes, it will automatically power-OFF.

When the handset is fully charged on the *Charging Station*, the *LED Indicator* is solid blue, yet blinks at 1 second intervals indicating the handset is not paired with any smart device.

While charging the handset on the *Charging Station*, the *LED Indicator* is solid red, yet flashes blue at 1 second intervals indicating the handset is not paired with any smart device.

When the handset is off the *Charging Station*, the *LED Indicator* flashes blue at 1 second intervals indicating the handset is not paired with any smart device.

### Maintaining Connectivity

Once paired, if the smart device and Beluga handset are separated beyond the recommended 10 meter (33 foot) limit, Bluetooth connectivity will be interrupted and the handset will enter the *disconnect mode*. To re-establish connectivity, move within the Bluetooth range again. Generally, if you are out of range for less than 15 minutes, re-establishing connectivity should be automatic. However, if your smart device is out of range with the Beluga handset for more than 15 minutes, the handset will automatically power-OFF to conserve battery life. As such, you will need to manually re-establish connectivity between the Beluga handset and the smart device. To do so, press and hold the *Multi-Function Button* for 8 seconds. The Beluga handset should then re-connect with your smart device without re-pairing.

## Multiple Point Pairing

Multi-point pairing allows you to pair more than one smart device to the Beluga handset.

1. Pair the Beluga Handset with the first smart device.
2. Power-OFF the handset.
3. Power-ON and enter the pairing mode for the handset by pressing and holding the *Multi-Function* Button for 10 seconds.
4. Pair the Beluga handset with the second smart device.
5. Select *Beluga* under *Devices* for the first smart device and re-connect to it.

The Beluga handset should be connected to two smart devices at the same time.

### IMPORTANT NOTICE

- Not all Bluetooth enabled smart devices perform in the same manner. Therefore, some functions may not be available after pairing the smart devices. Consult your smart device manufacturer for function compatibility with *Bluetooth*® 3.0 + EDR.
- The Beluga Bluetooth Intelligent Handset supports Multiple Point Pairing. However, the effectiveness of this feature will vary with the smart device used. If you experience a delay in voice connections, poor signal or call quality, you should pair only one device at a time with the Beluga handset.

## Re-Establishing Connectivity

There are a number of ways to re-establish connectivity depending on the state of your smart device and the Beluga handset. The following step applies to previously paired devices only.

1. Ensure the Beluga handset is a power-OFF state.
2. Ensure Bluetooth is active on your smart device.

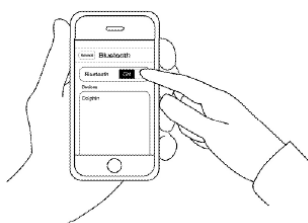

3. Press and hold the Multi-Function Button for approximately 5 seconds to power-ON and re-activate Bluetooth connectivity between the Beluga handset and the smart device.
4. You will hear some audible beeps emitting from the earpiece and see the LED Indicator flashing blue at eight second intervals, indicating the handset is in standby mode.

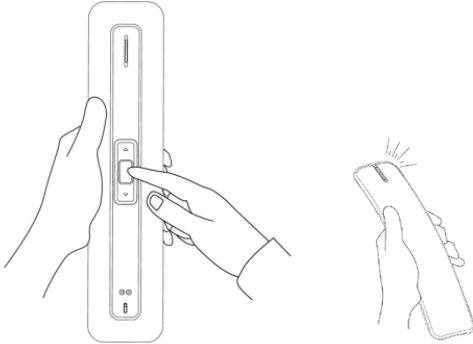

If you power-ON the Beluga handset before you enable Bluetooth on your smart device, you will need to search for the Beluga handset again and select it on your smart device.

#### Notes

- When in the *disconnect mode*, and depending on the time the Bluetooth connection has been broken, the Beluga handset will attempt to automatically pair with the Bluetooth-enabled smart device that has been previously paired with the Beluga handset. If connectivity is not made within 15 minutes, the handset will automatically power-OFF.
- If the Bluetooth-enabled smart device hasn't been paired with the Beluga handset before, it will not connect with the handset. Please pair the two units.
- When in the *disconnect mode*, if the previously-paired Bluetooth-enabled smart device cannot connect with the handset after many attempts, please pair both units again.
- If the handset does not power-ON, please give the handset a full charge and try again.

### Initiating Calls

Initiate calls through your smart device. Most devices offer an audio source selection. If so, select Beluga to use the Beluga handset.

## Answering Calls

1. When an incoming call is received on your smart device, an audible tone will be heard in the earpiece of the Beluga handset. During an incoming call, the *LED Indicator* will flash blue and red at one second intervals.
2. Press the *Multi-function Button* on the handset or the answer button on your smart device to accept the call.

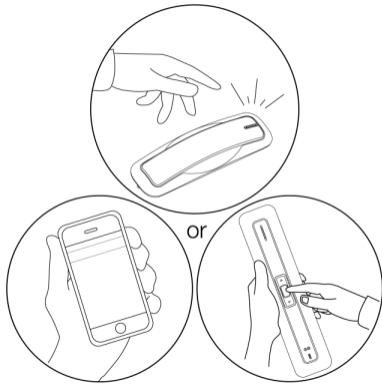

### Notes:

- When using an Android™ paired with the Beluga handset, the incoming call will be directed to the Beluga handset regardless of whether you push the *Multi-function Button* on the Beluga handset or the answer key on your Android smartphone.
- When using an iPhone® paired with the Beluga handset, the incoming call will be directed to the Beluga handset *only* if you push the *Multi-function Button* on the Beluga handset. If you push the answer button on the Apple iPhone, the call will be directed to the iPhone.
- Differences in smartphone operation with the Beluga handset will vary and do not indicate Beluga handset defects.

## Ending Calls

When you are ready to end a call, press the *Multi-function Button* on the Beluga handset or the *End* button on your smart device to end the call.

## Rejecting Calls

To reject an incoming call, press the *Multi-function Button* for 3 seconds, rejecting the call.

## Last Number Redial

While in *standby mode*, double-click the *Multi-function Button* rapidly to redial the last phone number dialed on your smart device.

Note:

Feature availability dependent upon smart device model and specific settings made within each smart device, which may disable this feature.

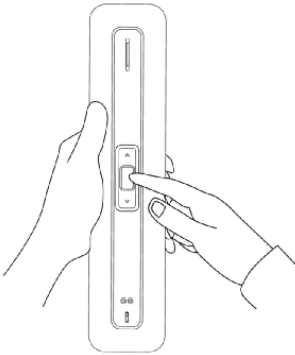

## Active Call Indications

When on an active call, the *LED Indicator* will flash at 5 second intervals.

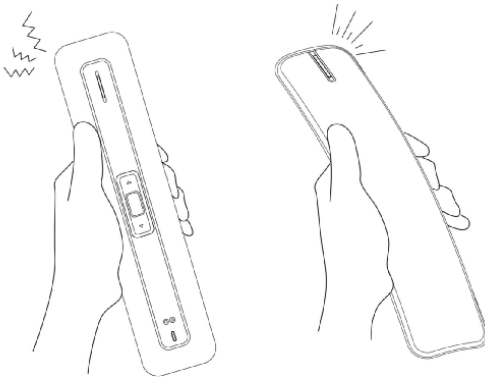

## Adjusting the Volume

While on a call, press the *Volume UP* or *Volume DOWN* to adjust the volume to a comfortable level.

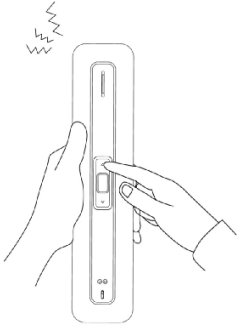

## Shifting Between Beluga Handset and Smart Device

1. During a call, press the *Multi-function Button* for 3 seconds, and you will hear an audible tone from the earpiece of the Beluga handset indicating you have successfully switched the voice path to your smart device.
2. To switch the voice path back to the Beluga handset, press the *Multi-function Button* for 3 seconds. An audible tone will be heard from the earpiece of the Beluga handset indicating successful switching of the voice path back to the Beluga handset. This process may be repeated as often as desired.

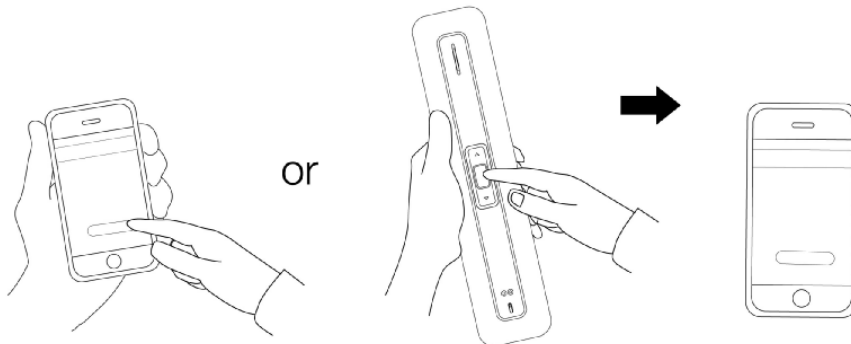

## Voice Control (optional with some smart devices)

1. While in *standby mode*, pressing the *Multi-function Button* may trigger your smart device voice control feature. If available, you can instruct the smart device to make a phone call, play music, etc. through voice commands made to the smart device through the Beluga handset.
2. Pressing the *Multi-function Button* again will cancel voice control and return the smart device to *standby mode*.

Note: Voice control features are entirely dependent on the smart device being used and settings made to the smart device, which may allow access to such features.

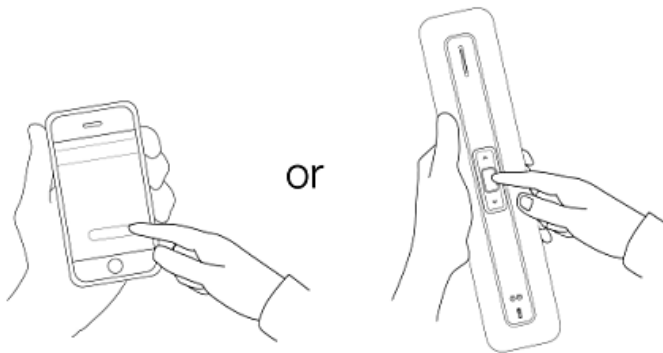

## Call Hold

1. While on a call, double clicking the *Multi-function Button* rapidly will put the call on hold.
2. Rapidly double-clicking the *Multi-function Button* again will reconnect the call.

Note: If you double-click too slowly, you may disconnect the call, so exercise care when using this feature.

## Call Swap, Call Reject, Call Disconnect

To accept a new incoming call (second call) and simultaneously put the first call on hold

1. While on a call, the handset will emit an audible beep at 5 second intervals as an indication of another incoming call.
2. Double-click the *Multi-function Button* rapidly to shift to the incoming call. The current (first) call will automatically be put on hold.

To return to the first call and put the second call on hold

- To return to the first call, double-click the *Multi-function Button* rapidly to shift back to the first call. The second call will automatically be put on hold.

To refuse a new incoming call

- Press and hold the *Multi-function Button* for 3 seconds to refuse a new incoming call, allowing you to remain connected with your current call.

To accept a new incoming call and disconnect your current call:

- Press the *Multi-function Button* once to disconnect the current call and accept a new incoming call.

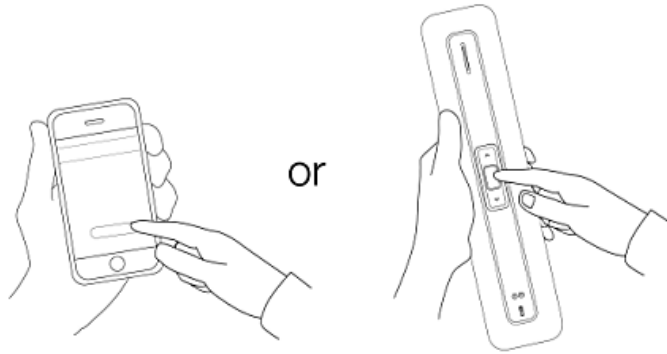

## Call Mute

1. While on a call, press the *Volume UP* button and *Volume DOWN* button at the same time for 5 seconds.
2. You will then hear an audible tone emitting from the earpiece at 5 second intervals indicating the Beluga handset has been muted. Although you will still be able to hear the other party, they will not be able to hear you.
3. To cancel call mute, press the *Volume UP* button and *Volume DOWN* button at the same time for 5 seconds, returning the Beluga handset to normal operations.

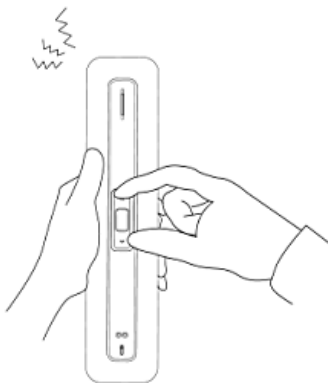



## Erasing Paired Data

During *power-ON*, *pairing* or *standby mode*, press the *Multi-function Button* and the *Volume UP* button for 10 seconds to erase all pairing data from the Beluga handset, and automatically *power-OFF* the handset. Once erased, you will need to delete the Device listing in your smart device and pair your smart device once with the Beluga handset. You will not be able to reuse the Device listing after you have erased the pairing data in the handset.

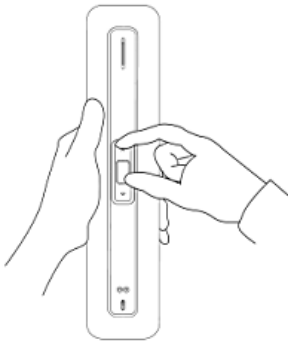

## Low Battery Indication

When the battery is too low to support Bluetooth handset operations, the *LED Indicator* will glow red.

## Charging the Beluga Handset

When you place the handset on the charging station and the *Charging Points* on the underside of the handset align with the *Power Pins* in the *Charging Station*, the *LED Indicator* glows red indicating charging is taking place. Once a full charge has been achieved, the *LED Indicator* will glow blue, indicating a full charge on the handset.

Note: The gold-plated *Charging Points* and *Power Pins* are sensitive to corrosion, especially from human hand sweat. For this reason, avoid touching the *Charging Points* or *Power Pins*.

If connectivity issues occur between the *Charging Points* and *Power Pins* gently wipe the *Charging Points* and *Power Pins* with a cotton swab immersed in 100% rubbing alcohol. Do not pour alcohol directly onto the *Charging Points and Power Pins*.

## Charging with the MicroUSB Charging Cable

The supplied *MicroUSB Charging Cable* allows you to charge the Beluga handset through the *Charging Station*.

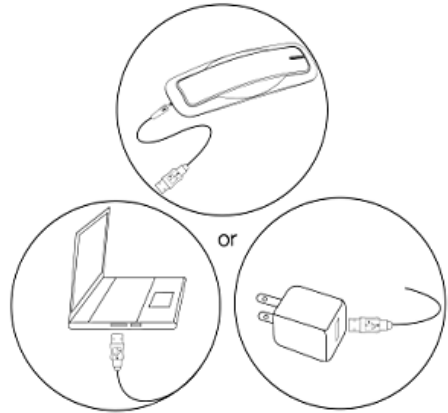

The *MicroUSB Charging Cable* can be connected directly to any USB charging port capable of supplying 5VDC, 500mA. Such USB charging ports are typically included with your smart device. Alternatively, you can charge the Beluga handset through the *Charging Station* connected directly to a computer USB port.

## SPECIFICATIONS

<i>Bluetooth</i> <sup>®</sup> version	3.0+EDR
Output power level	Class 2
Radio frequency	2.4GHz-2.48GHz
Maximum range (open space)	10 meters (33 feet)
Supported profiles	HSP & HFP
Charging time	2-3 hours
Talk time	15 hours
Standby time	250 hours
Power input	5VDC, 500mA (max.)
Power output	USB 2.0
Battery type	Lithium-ion Polymer
Dimensions	236 x 74 x 32 mm
Temperature Operating Range	0°C to 45°C (32°F to 113°F)

## TROUBLESHOOTING

Your Beluga Bluetooth Intelligent Handset was designed to deliver years of trouble-free service. However, certain configuration settings or missing feature sets in your smart device may prevent you from accessing all of the features described in this User Guide. If your Beluga is not performing as expected, and if you haven't already done so, please register your Beluga handset with us through [www.inter-tel.co.jp/products/beluga/registration](http://www.inter-tel.co.jp/products/beluga/registration). Once your registration is confirmed, you will be given access to our support portal. We promise to do our best to resolve any issue as quickly as possible.

## WARRANTY INFORMATION

Inter-Tel Japan, Inc. warrants that the Beluga Bluetooth Intelligent Handset (Product) will be free from defects in materials and workmanship for a period of one (1) year from the date of original purchase (the "Warranty Period"). To activate the warranty, the purchaser must register the handset within 14 days of purchase. Product activation can be executed at: [www.inter-tel.co.jp/products/beluga/registration](http://www.inter-tel.co.jp/products/beluga/registration). Inter-Tel Japan's sole and exclusive liability, and the Customer's sole remedy with respect to this warranty, shall apply only to Product which is: (i) returned to the factory or authorized repair point along with proof of purchase, with shipping charges prepaid by Customer, and (ii) after examination, determined to Inter-Tel Japan's satisfaction to be defective due to defects in materials and workmanship. This warranty does not apply to Product which has been repaired or modified without Inter-Tel Japan's written approval, or if Product was subjected to unusual physical, thermal or electrical stress, improper installation, misuse, abuse, accident or negligence in use, storage, transportation or handling. Repair or replacement does not extend the Warranty Period for such Product.

## FCC NOTICE

This device complies with part 15 of the FCC Rules. Operation is subject to the following two conditions:

1. This device may not cause harmful interference, and
2. This device must accept any interference received, including interference that may cause undesired operation.

This device has been tested and found to comply with the limits for a Class B digital device, pursuant to Part 15 of the FCC Rules. These limits are designed to provide reasonable protection against harmful interference in a residential installation. This device generates, uses and can radiated radio frequency energy and, if not installed and used in accordance with the instructions, may cause harmful interference to radio communications. However, there is no guarantee that interference will not occur in a particular installation. If this device does cause harmful interference to radio or television reception, which can be determined by turning the

device off and on, the user is encouraged to try to correct the interference by one or more of the following measures:

1. Reorient or relocate the receiving antenna.
2. Increase the separation between the device and the receiver.
3. Connect the device into an outlet on a circuit different from that to which the receiver is connected.
4. Consult the dealer or an experienced radio/TV technician for help.

Users are not permitted to make changes or modify the device in any way. Changes or modifications not expressly approved by the Inter-Tel Japan will void the user's authority to operate the device.

## CE

This device is CE marked according to the provisions of the R & TTE Directive (99/5/EC).

Hereby, Inter-Tel Japan, Inc. declares that this device is in compliance with the essential requirements and other relevant provisions of Directive 1999/5/EC. Please note that this device uses radio frequency bands not harmonized within EU. Within the EU this device is intended to be used in Austria, Belgium, Denmark, Finland, France, Germany, Greece, Ireland, Italy, Luxembourg, The Netherlands, Portugal, Spain, Sweden, United Kingdom and within EFTA in Iceland, Norway, and Switzerland.

## RoHS Compliance

This product is in compliance with Directive 2002/95/EC of the European Parliament and of the Council of 27 January 2003, on the restriction of the use of certain hazardous substances in electrical and electronic equipment (RoHS) and its amendments.

## WEEE Notice



The WEEE logo on the product or on its box indicates that this product must not be disposed of with your other household waste. You are liable for disposal of all of your electronic or electrical waste equipment at specified collection points for recycling of such hazardous waste. Isolated collection and proper recovery of your electronic and electrical waste equipment at the time of disposal will allow us to help conserve natural resources. Moreover, proper recycling of the electronic and electrical waste equipment will ensure safety of human health and the environment. For more information about electronic and electrical waste equipment disposal, recovery, and collection points, please contact your local city center, household waste disposal service, shop from where you purchased the equipment, or the manufacturer of the equipment.

## **Beluga *Bluetooth*® Intelligent Handset End User License Agreement**

THE BELUGA BLUETOOTH INTELLIGENT HANDSET (“PRODUCT”) CONTAINS CERTAIN PROPRIETARY TECHNOLOGY, THE USE OF WHICH IS SUBJECT TO THIS END USER LICENSE AGREEMENT (“EULA”). IF YOU (“END USER”) USE THE PRODUCT IN ANY MANNER, YOU ACCEPT THE TERMS AND CONDITIONS SET FORTH IN THIS “EULA” IN ITS ENTIRETY.

### **1. LICENSE**

Subject to the terms and conditions of this “EULA”, Inter-Tel Japan, Inc. (“Inter-Tel”) grants the “End User” a limited, non-exclusive, non-transferable (except as expressly permitted herein), license to execute and use the technology in object code form solely on the “Product” (“License”). “End User” has no right to receive any source code or design documentation relating to the technology.

### **2. RESTRICTIONS**

“Inter-Tel” and its partner companies shall at all times retain title, all ownership rights, and all intellectual property rights in and to the technology and any derivative works thereof. Except as expressly set forth in the “License” above, all rights are reserved by “Inter-Tel”. Without limiting the generality of the foregoing, “End User” shall not, nor shall “End User” allow any third party to:

(a) decompile, disassemble, decrypt, extract, or otherwise reverse engineer or attempt to reconstruct, or discover any technology used within the “Product” by any means whatsoever;

(b) remove or conceal any “Product” identification, copyright or other notices contained in or on the technology or accompanying documents;

(c) reproduce or modify the technology, incorporate it into or with other software or create a derivative work of any part of the “Product”.

3. The “Product” contains “Inter-Tel” and its partner companies confidential information as well as trade secrets. Such information is protected by copyrights and other intellectual property laws, as well as international treaties and other applicable laws. The “License” is personal to “End User”. End User shall not assign, sub-license or transfer the “License” or this “EULA” without “Inter-Tel’s” prior written approval.

### **4. TERMINATION OF “LICENSE”**

The “License” is effective until terminated. The “License” shall automatically terminate without notice if “End User” fails to comply with any term or condition set forth in this “EULA”. Upon termination of the “License”, “End User” shall immediately cease all use of the technology. “End User” obligations under this “EULA” shall survive termination.

## **WARRANTY DISCLAIMER**

TO THE MAXIMUM EXTENT PERMITTED BY LAW, THE TECHNOLOGY AND THE ACCOMPANYING DOCUMENTATION ARE PROVIDED "AS IS" AND "AS AVAILABLE," WITHOUT ANY WARRANTY, WHETHER EXPRESS, IMPLIED, STATUTORY, OR OTHERWISE, INCLUDING WITHOUT LIMITATION, THE IMPLIED WARRANTIES OF MERCHANTABILITY, TITLE, NON-INFRINGEMENT OF THIRD PARTY RIGHTS, AND FITNESS FOR A PARTICULAR PURPOSE.

## **LIMITATION OF LIABILITY**

TO THE MAXIMUM EXTENT PERMITTED BY LAW, IN NO EVENT SHALL "INTER-TEL" BE LIABLE FOR PERSONAL INJURY, OR ANY DIRECT, INCIDENTAL, SPECIAL, INDIRECT OR CONSEQUENTIAL DAMAGES WHATSOEVER, INCLUDING, WITHOUT LIMITATION, DAMAGES FOR LOST PROFITS, LOSS OF DATA, BUSINESS INTERRUPTION OR ANY OTHER COMMERCIAL OR PRIVATE DAMAGES OR LOSSES, ARISING OUT OF OR RELATED TO YOUR USE OF OR INABILITY TO USE THE TECHNOLOGY OR ANY THIRD PARTY SOFTWARE OR PRODUCTS IN CONJUNCTION WITH THE TECHNOLOGY, HOWEVER CAUSED, REGARDLESS OF THE THEORY OF LIABILITY (CONTRACT, TORT OR OTHERWISE) AND EVEN IF "INTER-TEL" HAS BEEN ADVISED OF THE POSSIBILITY OF SUCH DAMAGES. SOME JURISDICTIONS DO NOT ALLOW THE LIMITATION OF LIABILITY FOR PERSONAL INJURY, OR OF INCIDENTAL OR CONSEQUENTIAL DAMAGES, SO THIS LIMITATION MAY NOT APPLY TO YOU. THE FOREGOING LIMITATIONS APPLY EVEN IF THE ABOVE STATED REMEDY FAILS OF ITS ESSENTIAL PURPOSE.

## **COMPLIANCE WITH LAWS**

Any notice, report, approval, or consent required or permitted by this "EULA" shall be in writing. If any provision of this EULA shall be adjudged by any court of competent jurisdiction to be unenforceable or invalid, that provision shall be limited or eliminated to the minimum extent necessary so that the obligations of the parties shall remain in full force and effect and enforceable. "End User" agrees that a material breach of this "EULA" by it would cause irreparable injury to "Inter-Tel" for which monetary damages would not be an adequate remedy and that "Inter-Tel" shall be entitled to equitable relief in addition to any remedies it may have hereunder or at law. Any amendments or waivers shall be effective only if made in writing by non-preprinted agreements clearly understood by both parties to be an amendment or waiver and signed by an authorized representative of each party. This "EULA" is the final and complete agreement between the parties relating to the license of the technology.

## TRADEMARKS

Beluga *Bluetooth*® Intelligent Handset word mark logos are owned by Inter-Tel Japan, Inc. The *Bluetooth*® word mark and logos are registered trademarks owned by Bluetooth SIG, Inc. and any use of such marks by Inter-Tel Japan, K.K. is under license. Other trademarks and trade names are those of their respective owners.

iPhone® is a registered trademark of Apple Inc.

BlackBerry® is a registered trademark of Research In Motion Limited.

Android is a trademark of Google Inc. Use of this trademark is subject to Google Permissions [www.google.com/permissions/index.html](http://www.google.com/permissions/index.html)

For Beluga Bluetooth Intelligent Handset documentation in other languages and general support information, visit us at: [www.inter-tel.co.jp/products/beluga](http://www.inter-tel.co.jp/products/beluga)

The information and specifications in this document are subject to change without prior notice. Please visit [www.inter-tel.co.jp](http://www.inter-tel.co.jp) for the latest information concerning our products.

No part of this User Guide may be reproduced or copied by any means without the express written consent of Inter-Tel Japan, Inc.